

4

3

2

1

241-00-005  
Fastener, Custom: Nut, Bottom, R\_RL\_RLC

241-01-002  
Fastener, Custom: Crush Washer, Plastic, R\_RL\_RLC

TORQUE:  
50±5 IN.LB.  
(INTO FORK CHASSIS)

IMPORTANT:  
INSPECT 100% THAT RETAINING RING  
IS FULLY INSTALLED INTO GROOVE FULL 360°

038-00-091  
RETAINING RING

029-03-008  
O-Ring (-008) [.070 C.S. X .176 ID]

GREASE:  
THIN LAYER  
OF SLICK HONEY

TOPCAP ASSY

GREASE 2

TORQUE:  
220±5 IN.LB.  
(INTO FORK CHASSIS)

2 APPLY GREASE AROUND PISTON, TRANSFER SHAFT, ON 10MM SHAFT  
BETWEEN BUMPER AND NEG PLATE, AND A THIN LAYER ON ENTIRE  
LENGTH OF PISTON BORE OF UPPER TUBE ID.

234-04-811  
VOLUME SPACER

234-04-881  
AIR CAP

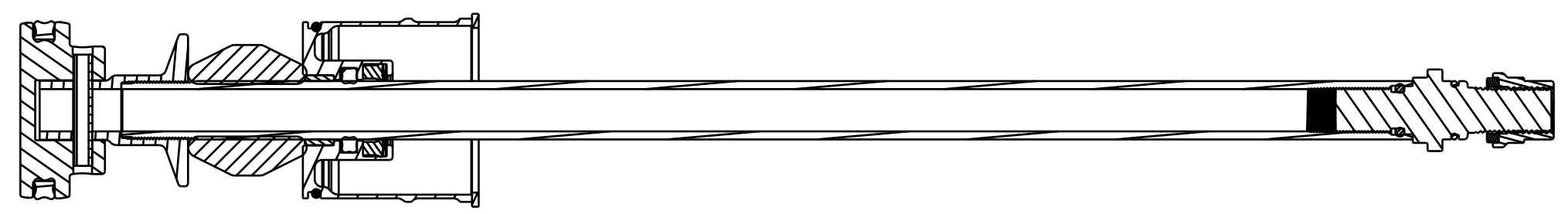
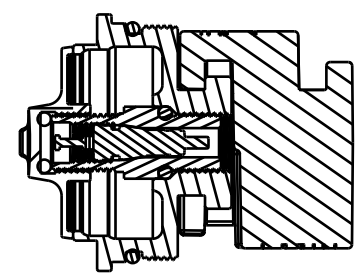

SECTION A-A

<b>FOX</b>		<b>FOX Factory, Inc.</b>	Ph 831-768-1100
		130 Hangar Way, Watsonville, CA 95076 USA	Fax 831-768-9312
TITLE			
<b>Air Spring, FLOAT NA 2</b>			
SIZE DWG. NO.			
<b>C</b>			
PLOT SCALE   .00:1		SHEET   OF   1	

- PROPRIETARY -  
THIS DOCUMENT CONTAINS CONFIDENTIAL, PROPRIETARY INFORMATION  
THAT IS FOX PROPERTY. DO NOT DISCLOSE TO OR DUPLICATE  
FOR OTHERS EXCEPT AS AUTHORIZED BY FOX.

4

3

2

ProE ASSEM